

Samsung ME-C Series Commercial LED LCD Displays

Deploy your content with impact.
And manage it with ease.

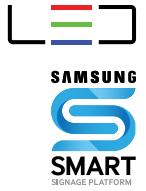

Digital Signage Versatility and Control in High Definition

The ME-C Series is proof that you can control your messaging as seamlessly as you deploy it. Featuring a sleek, stylish design aesthetic, these ultra-slim and lightweight edge-lit displays deliver a high-resolution screen and integrated TV tuner, with simple display control through the RS232C and RJ45 ports. Increased energy savings of 35% or more over CCFL backlit displays means a lower TCO, with even more opportunity to save money (and headaches) with the SMART Signage Platform functionality. And the ultra-slim chassis with slim bezel design helps simplify installation and provides a more impactful message. In any setting from retail to restaurants, or public spaces to conference rooms. The ME-C Series. Deploy and manage, beautifully. **Business. Innovated.**



Edge-Lit, Ultra-Slim HD LED Screen

The edge-lit 32"/40"/46"/55" displays of the ME-C Series feature 1920 x 1080 Full HD resolution with 450 nits brightness and 5000:1 contrast ratio for sharp, detail-rich images and crisp, easily legible type. And the stylish 1.2" thin chassis helps simplify installation and makes it suitable for most locations.



Optional Touch Overlay

Add an optional IR touch overlay accessory to enable up to 6 simultaneous touch points.



Narrow Bezels

The slim bezel design of the ME-C Series ensures that nothing gets in the way of what's on screen. The result is messaging with maximum impact.



Integrated TV Tuner

Provides the option of easily displaying broadcast TV.



Lower TCO

LED technology consumes an average of 40% less power, for lower total cost of ownership.



SMART Signage Platform

This integrated, open platform provides a powerful streamlined solution that reduces TCO for digital signage deployments, providing savings in hardware, installation and operating costs.



Learn more ▶ 1-800-SAMSUNG | 1-866-SAM4BIZ | samsung.com/prodisplay or samsung.com/business

Follow us: [@SamsungBizUSA](https://twitter.com/SamsungBizUSA) | [YouTube youtube.com/samsungbizusa](https://www.youtube.com/samsungbizusa)

Samsung ME-C Series Commercial LED LCD Displays



KEY SPECIFICATIONS For complete product specifications, visit samsung.com/prodisplay

Display	Model Number	ME32C	ME40C	ME46C	ME55C
Screen Size		32"	40"	46"	55"
Panel Technology		60Hz (Edge-LED Backlight)	60Hz (Edge-LED Backlight)	60Hz (Edge-LED Backlight)	120Hz (Edge-LED Backlight)
Resolution		1920 x 1080	1920 x 1080	1920 x 1080	1920 x 1080
Brightness (cd/m ²)		450 nit	450 nit	450 nit	450 nit
Contrast Ratio (Typical)		5000:1	5000:1	5000:1	5000:1
Viewing Angle		178°/178°	178°/178°	178°/178°	178°/178°
Orientation		Landscape/Portrait	Landscape/Portrait	Landscape/Portrait	Landscape/Portrait
Response Time		8ms	8ms	8ms	8ms
Connectivity	Input	VGA (D-Sub 15 Pin), DVI-D (In/Out), 2 HDMI, DisplayPort 1.2, Component (CVBS Common), USB, Stereo Mini Jack, TV In	VGA (D-Sub 15 Pin), DVI-D (In/Out), 2 HDMI, DisplayPort 1.2, Component (CVBS Common), USB, Stereo Mini Jack, TV In	VGA (D-Sub 15 Pin), DVI-D (In/Out), 2 HDMI, DisplayPort 1.2, Component (CVBS Common), USB, Stereo Mini Jack, TV In	VGA (D-Sub 15 Pin), DVI-D (In/Out), 2 HDMI, DisplayPort 1.2, Component (CVBS Common), USB, Stereo Mini Jack, TV In
	Output	DP1.2 (Loop-out), Stereo Mini Jack	DP1.2 (Loop-out), Stereo Mini Jack	DP1.2 (Loop-out), Stereo Mini Jack	DP1.2 (Loop-out), Stereo Mini Jack
	External Control	RJ45, RS232C (In/Out) thru stereo jack	RJ45, RS232C (In/Out) thru stereo jack	RJ45, RS232C (In/Out) thru stereo jack	RJ45, RS232C (In/Out) thru stereo jack
	External Sensor	IR/Ambient Light	IR/Ambient Light	IR/Ambient Light	IR/Ambient Light
Power	Power Supply	AC 100 - 240 V~ (+/- 10 %), 50/60 Hz	AC 100 - 240 V~ (+/- 10 %), 50/60 Hz	AC 100 - 240 V~ (+/- 10 %), 50/60 Hz	AC 100 - 240 V~ (+/- 10 %), 50/60 Hz
	Power Consumption (Typical/Max)	62W / 77W	93W / 110W	97W / 121W	122W / 143W
	Power Consumption (Standby)	<0.5W	<0.5W	<0.5W	<0.5W
Environmental Conditions	Operating Temperature	0° C - 40° C	0° C - 40° C	0° C - 40° C	0° C - 40° C
	Operating Humidity	10 - 80%	10 - 80%	10 - 80%	10 - 80%
Features	Special	Magic Clone (to USB), Auto Source Switching & Recovery, Lamp Error Detection, Super Clear Coating, Temperature Sensor, Plug and Play (DDC2B), Pivot Display, Clock Battery, PIP/PBP, Video Wall (10x10), Image Rotation, Button Lock, HDCP Support, Smart Scheduling, Smart F/W update, Built-In MagicInfo Premium-S	Magic Clone (to USB), Auto Source Switching & Recovery, Lamp Error Detection, Super Clear Coating, Temperature Sensor, Plug and Play (DDC2B), Pivot Display, Clock Battery, PIP/PBP, Video Wall (10x10), Image Rotation, Button Lock, HDCP Support, Smart Scheduling, Smart F/W update, Built-In MagicInfo Premium-S	Magic Clone (to USB), Auto Source Switching & Recovery, Lamp Error Detection, Super Clear Coating, Temperature Sensor, Plug and Play (DDC2B), Pivot Display, Clock Battery, PIP/PBP, Video Wall (10x10), Image Rotation, Button Lock, HDCP Support, Smart Scheduling, Smart F/W update, Built-In MagicInfo Premium-S	Magic Clone (to USB), Auto Source Switching & Recovery, Lamp Error Detection, Super Clear Coating, Temperature Sensor, Plug and Play (DDC2B), Pivot Display, Clock Battery, PIP/PBP, Video Wall (10x10), Image Rotation, Button Lock, HDCP Support, Smart Scheduling, Smart F/W update, Built-In MagicInfo Premium-S
	SMART Signage Platform Compliant	Yes	Yes	Yes	Yes
	Tuner	Yes	Yes	Yes	Yes
	Internal Media Player	Cortex-A9 1Ghz Dual Core, 1GB DDR3, 8GB FDM, USB (2)	Cortex-A9 1Ghz Dual Core, 1GB DDR3, 8GB FDM, USB (2)	Cortex-A9 1Ghz Dual Core, 1GB DDR3, 8GB FDM, USB (2)	Cortex-A9 1Ghz Dual Core, 1GB DDR3, 8GB FDM, USB (2)
	VESA Standard Wall Mount Interface	200 x 200mm	200 x 200mm	400 x 400mm	400 x 400mm
Dimensions	Product Dimensions (without stand)	28.9" x 17.1" x 1.2"	36.3" x 21.2" x 1.2"	41.6" x 24.2" x 1.2"	49.1" x 28.4" x 1.2"
	Packaging Dimensions	32.8" x 20.4" x 4.7"	40.2" x 24.3" x 5.1"	46" x 28.4" x 5.5"	53.9" x 33.4" x 7.8"
	Bezel Width	16.2mm (Bottom 20.8mm)	16.2mm (Bottom 20.9mm)	17.3mm (Bottom 20.9mm)	17.2mm (Bottom 20.8mm)
	Weight	Product Weight Shipping Weight	14.8 lbs. 18.3 lbs.	23.4 lbs. 27.8 lbs.	28.9 lbs. 36.8 lbs.
Service	Standard Warranty	3 Years On-Site (Parts/Labor)	3 Years On-Site (Parts/Labor)	3 Years On-Site (Parts/Labor)	3 Years On-Site (Parts/Labor)
Accessories	Included	Quick Setup Guide, Warranty Card, Application CD, D-Sub Cable, Power Cord, Remote Controller, Batteries, RS232C to Stereo Gender in/out Cable, Component Gender, Holder P-Ring, Holder Wire Stand	Quick Setup Guide, Warranty Card, Application CD, D-Sub Cable, Power Cord, Remote Controller, Batteries	Quick Setup Guide, Warranty Card, Application CD, D-Sub Cable, Power Cord, Remote Controller, Batteries	Quick Setup Guide, Warranty Card, Application CD, D-Sub Cable, Power Cord, Remote Controller, Batteries
	Optional Stand	STN-L32D	STN-L4055AD	STN-L4055AD	STN-L4055AD
	Optional Mount	WMN4070SD, WMN250MD	WMN4070SD, WMN250MD	WMN4270SD, WMN250MD	WMN4270SD, WMN250MD
	Optional Media Player	SBB-C, SBB-CD7, SBB-CQ7	SBB-C, SBB-CD7, SBB-CQ7	SBB-C, SBB-CD7, SBB-CQ7	SBB-C, SBB-CD7, SBB-CQ7
Green Management	Emission Standard	EMC	EMC	EMC	EMC
	ENERGY STAR® 5.0 Compliant	Yes	Yes	Yes	Yes
	RoHS Compliant	Yes	Yes	Yes	Yes
	Packaging Recyclability	Packing Materials Recyclable	Packing Materials Recyclable	Packing Materials Recyclable	Packing Materials Recyclable

CONNECTIVITY

- RS232C In
- RS232C Out
- IR/Ambient Sensor In
- Audio Out
- Audio In
- USB
- HDMI In 2
- DisplayPort In
- HDMI In 1
- DVI In
- DisplayPort Out
- Antenna In
- RGB In
- AV In
- IR Out
- RJ45 In

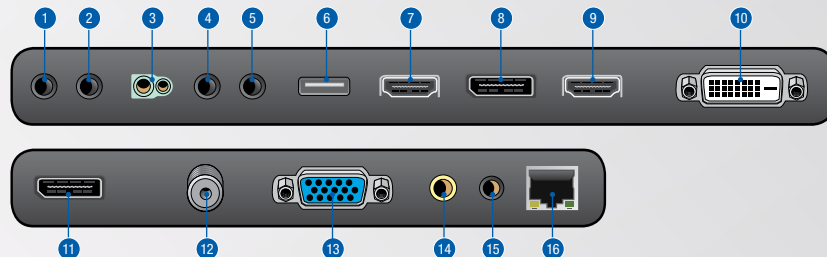

For complete product information and accessories, visit samsung.com/prodisplay or samsung.com/business

Follow us: [@SamsungBizUSA](https://twitter.com/SamsungBizUSA) | [YouTube youtube.com/samsungbizusa](https://www.youtube.com/samsungbizusa)

Samsung Electronics has been named 2012 ENERGY STAR Partner of the Year in the product manufacturing category by the U.S. Environmental Protection Agency (EPA).



Product Support: 1-800-SAMSUNG
1-866-SAM4BIZ

©2013 Samsung Electronics America, Inc. Samsung is a registered mark of Samsung Electronics Corp., Ltd. Specifications and designs are subject to change without notice. Non-metric weights and measurements are approximate. All other brand, product, service names and logos are trademarks and/or registered trademarks of their respective manufacturers and companies. Simulated screen images. See samsung.com for detailed information. Printed in USA. LFD-MECSEIESB2BDSHT-JUN13T

